

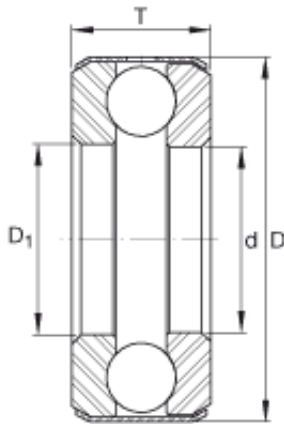

## Bearing equipment manufacturing Co., Ltd



B14 Bearing 2D drawings and 3D CAD models

### INA B14 thrust ball bearings

Bearing No. B14

Size	33.338x59.54x19.05 mm
Bore Diameter	33,338 mm
Outer Diameter	59,54 mm
Width	19,05 mm
d	1 5/16 inch
d	33,338 mm
D	2,344 inch
D	59,54 mm
T	0,75 inch
T	19,05 mm
D <sub>1</sub>	1,354 inch
m	0,481 lbs / Weight
m	0,218 kg / Weight
C <sub>a</sub>	9300 lbf / Dynamic load rating (axial)
C <sub>a</sub>	41400 N / Dynamic load rating (axial)
C <sub>0a</sub>	18800 lbf / Static load rating (axial)
C <sub>0a</sub>	84000 N / Static load rating (axial)
Category	Thrust Ball Bearing
Inventory	0.0
Manufacturer Name	SCHAEFFLER GROUP
Minimum Buy Quantity	N/A
Weight / Kilogram	0.22
EAN	4054364115494



## Bearing equipment manufacturing Co., Ltd

Product Group	B00308
Rolling Element	Ball Bearing
Thrust Bearing	Yes
Single or Double Direction	Single Direction
Banded	Yes
Precision Class	ABEC 1   ISO P0
Component Description	Roller Assembly Plus Raceways
Other Features	Single Row   Deep Groove   Medium Cross Section   Grooved Race   Non Separable   Full Complement   Standard Oil Hole in Band
Long Description	1-5/16" Bore 1; 1.354" Bore 2; 2-11/32" Outside Diameter; 3/4" Height; Ball Bearing; Single Direction; Banded; ABEC 1   ISO P0 Precision
Inch - Metric	Inch
Category	Thrust Ball Bearings
UNSPSC	31171507
Harmonized Tariff Code	8482.10.50.08
Noun	Bearing
Keyword String	Ball Thrust
Manufacturer URL	<a href="http://www.ina.com">http://www.ina.com</a>
Manufacturer Item Number	B14
Weight / LBS	0.481
Overall Height with Aligning Washer	0 Inch   0 Millimeter
Bore 1	1.313 Inch   33.35 Millimeter
Bore 2	1.354 Inch   34.392 Millimeter
Outside Diameter	2.344 Inch   59.538 Millimeter



## Bearing equipment manufacturing Co., Ltd

Height	0.75 Inch   19.05 Millimeter
--------	------------------------------