

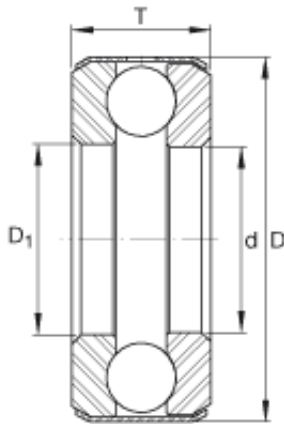

Bearing equipment manufacturing Co., Ltd



INA D25 thrust ball bearings

Bearing No. D25

Size	50.8x84.938x20.65 mm
Bore Diameter	50,8 mm
Outer Diameter	84,938 mm
Width	20,65 mm
d	2 inch
d	50,8 mm
D	3,344 inch
D	84,938 mm
T	0,813 inch
T	20,65 mm
D ₁	2,031 inch
m	0,96 lbs / Weight
m	433 g / Weight
C _a	10800 lbf / Dynamic load rating (axial)
C _a	48000 N / Dynamic load rating (axial)
C _{0a}	29000 lbf / Static load rating (axial)
C _{0a}	129000 N / Static load rating (axial)
Category	Thrust Ball Bearing
Inventory	1.0
Manufacturer Name	SCHAEFFLER GROUP
Minimum Buy Quantity	N/A
Weight / Kilogram	0.433
EAN	0035373029938

D25 Bearing 2D drawings and 3D CAD models



Bearing equipment manufacturing Co., Ltd

Product Group	B00308
Rolling Element	Ball Bearing
Thrust Bearing	Yes
Single or Double Direction	Single Direction
Banded	Yes
Cage Material	Steel
Precision Class	ABEC 1 ISO P0
Component Description	Roller Assembly Plus Raceways
Other Features	Single Row
Long Description	2" Bore 1; 2-1/32" Bore 2; 3-11/32" Outside Diameter; 13/16" Height; Ball Bearing; Single Direction; Banded; Steel Cage; ABEC 1 ISO P0 Precision
Inch - Metric	Inch
Category	Thrust Ball Bearings
UNSPSC	31171552
Harmonized Tariff Code	8482.10.50.08
Noun	Bearing
Keyword String	Ball Thrust
Manufacturer URL	http://www.ina.com
Weight / LBS	0.975
Bore 2	2.031 Inch 51.587 Millimeter
Overall Height with Aligning Washer	0 Inch 0 Millimeter
Height	0.813 Inch 20.65 Millimeter
Bore 1	2 Inch 50.8 Millimeter
Outside Diameter	3.344 Inch 84.938 Millimeter