

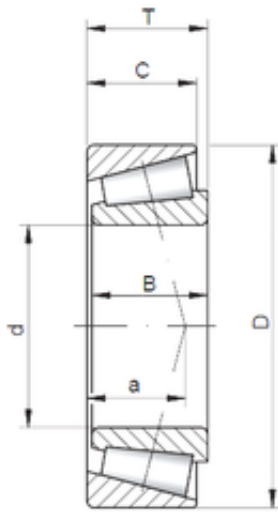

Bearing equipment manufacturing Co., Ltd



50 mm x 82 mm x 21,5 mm ISO JLM104948/10 tapered roller bearings

Bearing No. JLM104948/10

Size	50x82x21.5 mm
Bore Diameter	50 mm
Outer Diameter	82 mm
Width	21,5 mm
d	50 mm
D	82 mm
T	21,5 mm
B	21,5 mm
C	17 mm
a	5,3 mm

JLM104948/10 Bearing 2D drawings and 3D CAD models