

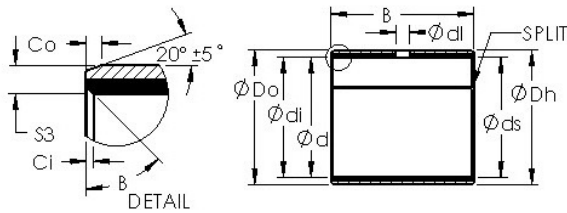

Bearing equipment manufacturing Co., Ltd



AST AST40 25080 plain bearings

Bearing No. AST40 25080

Bore Diameter	250 mm
Outer Diameter	255 mm
Bearing Type	straight
Shaft Dia., Nominal (d)	250.0000
Shaft Size (ds) - 250 -0 / -0.072	250 0 / 0.072
Housing Bore Dia. (Dh)	255 +0.052 / +0
Bearing Outside Diameter, Nominal(Do)	255.000
Bearing Outside Diameter Tolerance (Do tol.)	255.26 / 255.17
Bearing Bore after Mounting (di)	250.222 / 250.07
Average Clearance (Cd)	0.1820
Wall Thickness (S3)	2.465
Bearing Length, Nominal (B)	80.000
Bearing Length Tolerance (B tol.) - +0 / -0.40	+0 / 0.40
OD Chamfer Length (Co)	1.800
ID Chamfer Angle (B deg.)	45
ID Chamfer Length (Ci)	0.600
Material	Steel shell with PTFE / Polymer Fiber lining

AST40 25080 Bearing 2D drawings and 3D CAD models