

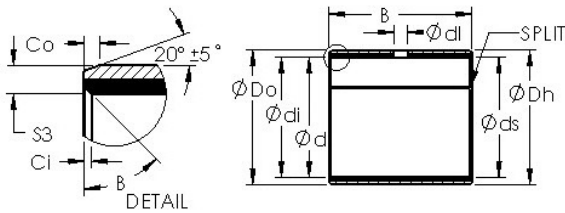

Bearing equipment manufacturing Co., Ltd



AST AST11 2525 plain bearings

Bearing No. AST11 2525

Bore Diameter	25 mm
Outer Diameter	28 mm
Bearing Type	straight
Shaft Dia., Nominal (d)	25.0000
Shaft Size (ds) - 25 -0.02 / -0.041	25 0.02 / 0.041
Housing Bore Dia. (Dh)	28 +0.021 / +0
Bearing Outside Diameter, Nominal(Do)	28.000
Bearing Outside Diameter Tolerance (Do tol.)	28.075 / 28.035
Bearing Bore after Mounting (di)	25.071 / 24.99
Average Clearance (Cd)	0.0610
Wall Thickness (S3)	1.505
Bearing Length, Nominal (B)	25.000
Bearing Length Tolerance (B tol.) - +0 / -0.30	+0 / 0.30
OD Chamfer Length (Co)	0.700
ID Chamfer Angle (B deg.)	30
ID Chamfer Length (Ci)	0.500
Material	Bronze shell with PTFE / Fiber lining

AST11 2525 Bearing 2D drawings and 3D CAD models