

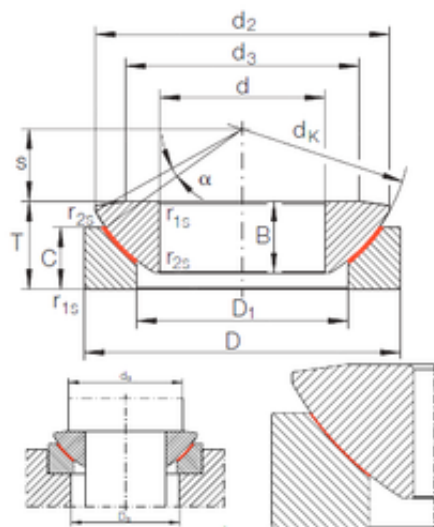

Bearing equipment manufacturing Co., Ltd



300 mm x 480 mm x 100 mm INA GE 300 AW
plain bearings

Bearing No. GE 300 AW

Size	300x480x110 mm
Bore Diameter	300 mm
Outer Diameter	480 mm
Width	110 mm
d	300 mm
D	480 mm
T	110 mm
B	100 mm
C	90 mm
d2	460 mm
d3	388 mm
dk	490 mm
r1 min.	3 mm
r2 min.	1 mm
D1	356 mm
S	80 mm
da max	388 mm
Da min	375 mm
Angle	3,5 °
Weight	88,5 Kg
Basic dynamic load rating (C)	17280 kN

GE 300 AW Bearing 2D drawings and 3D CAD models