

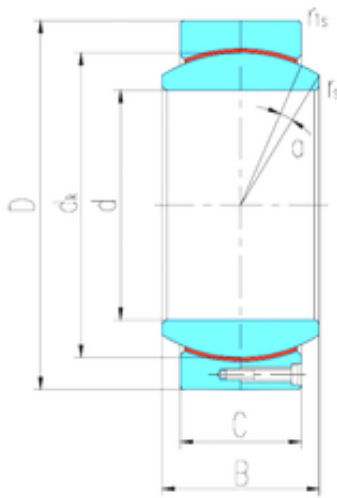

## Bearing equipment manufacturing Co., Ltd



530 mm x 710 mm x 243 mm LS GEC530HT  
plain bearings

Bearing No. GEC530HT

Size	530x710x243 mm
Bore Diameter	530 mm
Outer Diameter	710 mm
Width	243 mm
d	530 mm
D	710 mm
B	243 mm
C	205 mm
dk	620 mm
r min.	2 mm
r1 min.	5 mm
Angle	3 °
Weight	294 Kg
Basic dynamic load rating (C)	22870 kN

GEC530HT Bearing 2D drawings and 3D CAD models