

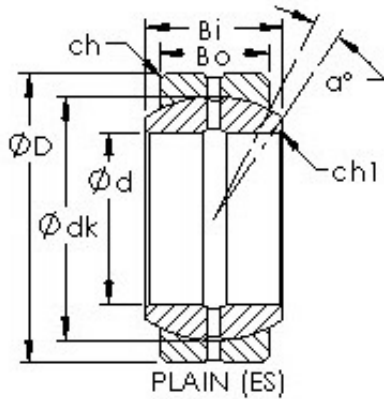

Bearing equipment manufacturing Co., Ltd



AST GEZ19ES plain bearings

Bearing No. GEZ19ES

Bore Diameter	19,05 mm
Outer Diameter	31,75 mm
Bearing Type	plain
Bore Dia (d)	0.7500
Outer Dia (D)	1.2500
Outer Width (Bo)	0.5620
Inner Width (Bi)	0.6560
Dynamic Load Rating (Cr)	6,969
Static Load Rating (Cor)	21,356
Max. shaft corner radius, or 45 deg. chamfer (ch1)	0.012
Max. housing corner radius, or 45 deg. chamfer (ch)	0.024
Spherical Diameter (dk or Dk)	1.083
Mis-alignment Angle (a deg.)	6
Weight (g)	53.00
Material	52100 Chrome steel, or equivalent

GEZ19ES Bearing 2D drawings and 3D CAD models