

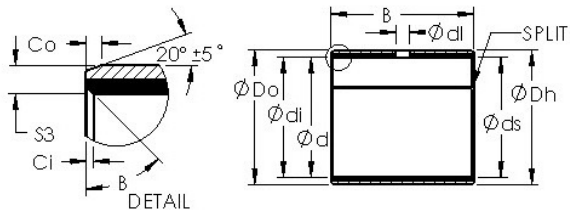

Bearing equipment manufacturing Co., Ltd



AST AST50 56IB48 plain bearings

Bearing No. AST50 56IB48

Bore Diameter	88,9 mm
Bearing Type	straight
Shaft Dia., Nominal (d)	3.5000
Shaft Size (ds) - 3.5	3.4978
Housing Bore Dia. (Dh) - 3.6872	3.6858
Bearing Bore after Mounting (di) - 3.5068	3.5002
Average Clearance (Cd)	0.0046
Wall Thickness (S3)	0.095
Bearing Length, Nominal (B)	3.000
Bearing Length Tolerance (B tol.) - +.010 / -0.010	+.010 / 0.010
OD Chamfer Length (Co)	0.072
ID Chamfer Angle (B deg.)	30
ID Chamfer Length (Ci)	0.031
Material	Carbon steel shell with PTFE / Fiber lining

AST50 56IB48 Bearing 2D drawings and 3D CAD models