

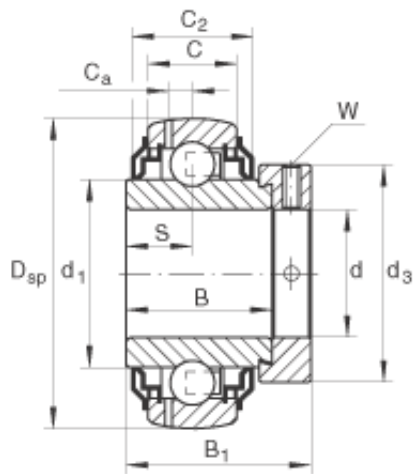

Bearing equipment manufacturing Co., Ltd



INA GE40-KRR-B-2C deep groove ball bearings

Bearing No. GE40-KRR-B-2C

GE40-KRR-B-2C Bearing 2D drawings and 3D CAD models

Size	40x80x56.5 mm
Bore Diameter	40 mm
Outer Diameter	80 mm
Width	56,5 mm
d	40 mm
D _{SP}	80 mm
B ₁	56,5 mm
B	42,9 mm
C	21 mm
C ₂	31,9 mm
C _a	6,4 mm
d ₁	52,3 mm
d _{3 max}	58 mm
S	21,4 mm
W	5 mm
m	0,78 kg / Weight
C _r	34500 N / Dynamic load rating (radial)
C _{0r}	19800 N / Static load rating (radial)
Category	Bearings
Inventory	0.0
Manufacturer Name	SCHAEFFLER GROUP
Minimum Buy Quantity	N/A
Weight / Kilogram	0.78



Bearing equipment manufacturing Co., Ltd

Product Group	
---------------	--

	B04264
--	--------