

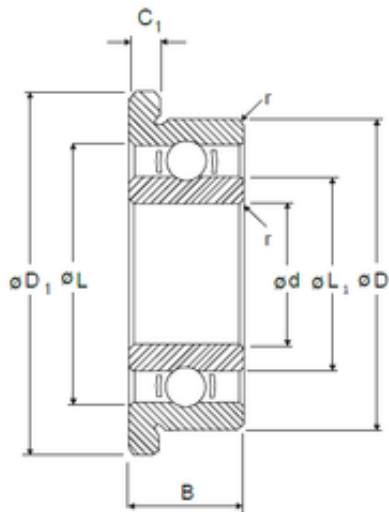

Bearing equipment manufacturing Co., Ltd



2,5 mm x 6 mm x 1,8 mm NMB LF-625 deep groove ball bearings

Bearing No. LF-625

Size	2.5x6x1.8 mm
Bore Diameter	2,5 mm
Outer Diameter	6 mm
Width	1,8 mm
d	2,5 mm
D	6 mm
B	1,8 mm
C	1,8 mm
r min.	0,08 mm
C1	0,5 mm
D1	7,1 mm
L	4,93 mm
L1	3,8 mm
Basic dynamic load rating (C)	0,206 kN

LF-625 Bearing 2D drawings and 3D CAD models