

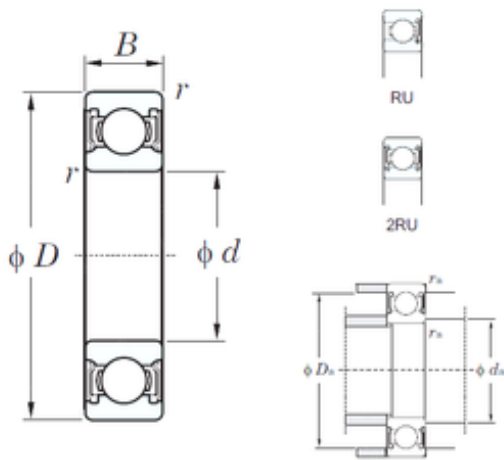

## Bearing equipment manufacturing Co., Ltd



10 mm x 35 mm x 11 mm KOYO 6300-2RU  
deep groove ball bearings

Bearing No. 6300-2RU

Size	10x35x11 mm
Bore Diameter	10 mm
Outer Diameter	35 mm
Width	11 mm
d	10 mm
D	35 mm
B	11 mm
C	11 mm
r min.	0,6 mm
da min.	14 mm
da max	16 mm
Da max.	31 mm
ra max.	0,6 mm
Weight	0,053 Kg
Basic dynamic load rating (C)	8,1 kN
Basic static load rating (C0)	3,45 kN
(Grease) Lubrication Speed	22000 r/min

6300-2RU Bearing 2D drawings and 3D CAD models