

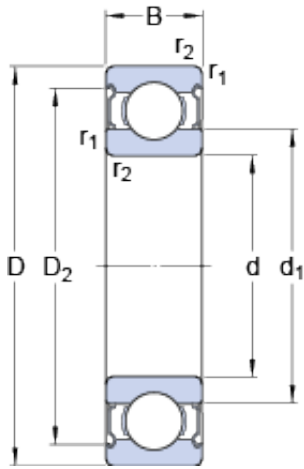

Bearing equipment manufacturing Co., Ltd



150 mm x 225 mm x 35 mm SKF 6030-2Z deep groove ball bearings

Bearing No. 6030-2Z

6030-2Z Bearing 2D drawings and 3D CAD models

Size	225x150x35 mm
Bore Diameter	225 mm
Outer Diameter	150 mm
Width	35 mm
d	150 mm
D	225 mm
B	35 mm
d ₁	174.15 mm
D ₂	205.3 mm
r _{1,2} - min.	2.1 mm
d _a - min.	160 mm
d _a - max.	173.9 mm
D _a - max.	215 mm
r _a - max.	2 mm
Basic dynamic load rating - C	125 kN
Basic static load rating - C ₀	125 kN
Fatigue load limit - P _u	3.9 kN
Reference speed	6000 r/min
Limiting speed	3000 r/min
Calculation factor - k _r	0.025
Calculation factor - f ₀	15.9
Category	Single Row Ball Bearings
Inventory	0.0
Manufacturer Name	SKF



Bearing equipment manufacturing Co., Ltd

Minimum Buy Quantity	N/A
Weight / Kilogram	4.48
EAN	7316570285130
Product Group	B00308
Enclosure	2 Metal Shields
Precision Class	ABEC 1 ISO P0
Maximum Capacity / Filling Slot	No
Rolling Element	Ball Bearing
Snap Ring	No
Internal Special Features	No
Cage Material	Steel
Internal Clearance	C0-Medium
Inch - Metric	Metric
Long Description	150MM Bore; 225MM Outside Diameter; 35MM Outer Race Diameter; 2 Metal Shields; Ball Bearing; ABEC 1 ISO P0; No Filling Slot; No Snap Ring; No Internal Special Features
Category	Single Row Ball Bearing
UNSPSC	31171504
Harmonized Tariff Code	8482.10.50.68
Noun	Bearing
Keyword String	Ball
Manufacturer URL	http://www.skf.com
Manufacturer Item Number	6030-2Z
Weight / LBS	9.388
Bore	5.906 Inch 150 Millimeter
Outer Race Width	1.378 Inch 35 Millimeter
Outside Diameter	8.858 Inch 225 Millimeter
d ₁	174.15 mm
D ₂	205.3 mm



Bearing equipment manufacturing Co., Ltd

$r_{1,2}$ min.	2.1 mm
d_a min.	160 mm
d_a max.	173.9 mm
D_a max.	215 mm
r_a max.	2 mm
Basic dynamic load rating C	125 kN
Basic static load rating C_0	125 kN
Fatigue load limit P_u	3.9 kN
Calculation factor k_r	0.025
Calculation factor f_0	15.9
Mass bearing	4.38 kg