

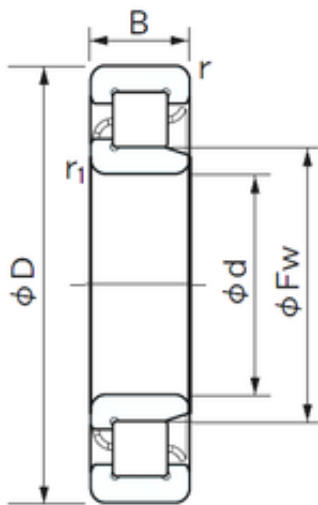

## Bearing equipment manufacturing Co., Ltd



240 mm x 360 mm x 56 mm NACHI NJ 1048  
cylindrical roller bearings

Bearing No. NJ 1048

Size	240x360x56 mm
Bore Diameter	240 mm
Outer Diameter	360 mm
Width	56 mm
d	240 mm
Fw	270 mm
D	360 mm
B	56 mm
r min.	3 mm
r1 min.	3 mm
Weight	20.4 Kg
Basic dynamic load rating (C)	500 kN
Basic static load rating (C0)	755 kN
(Grease) Lubrication Speed	1700 r/min

NJ 1048 Bearing 2D drawings and 3D CAD models